

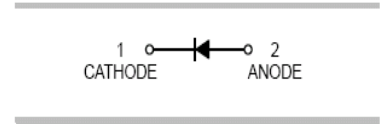

### FEATURES

- General rectification
- Low  $V_F$ ; Low  $I_R$
- High reliability



### APPLICATIONS

- General rectification

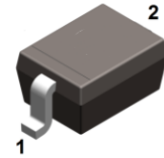

SOD-323

### ORDERING INFORMATION

Type No.	Marking	Package Code
RB550V-30	S.	SOD-323

### MAXIMUM RATING @ $T_a=25^\circ\text{C}$ unless otherwise specified

Parameter	Symbol	Limits	Unit
Peak reverse voltage	$V_{RM}$	30	V
DC reverse voltage	$V_R$	30	V
Mean rectifying current	$I_O$	1	A
Peak forward surge current	$I_{FSM}$	3	A
Junction temperature	$T_J$	-40 to +150	$^\circ\text{C}$
Storage temperature	$T_{STG}$	-40 to +150	$^\circ\text{C}$

### ELECTRICAL CHARACTERISTICS @ $T_a=25^\circ\text{C}$ unless otherwise specified

Parameter	Symbol	Min.	Typ.	Max.	Unit	Conditions
Forward voltage	$V_F$			0.52 0.55	V	$I_F=700\text{mA}$ $I_F=1\text{A}$
Reverse current	$I_R$		1	20	$\mu\text{A}$	$V_R=10\text{V}$



### TYPICAL CHARACTERISTICS @ Ta=25°C unless otherwise specified

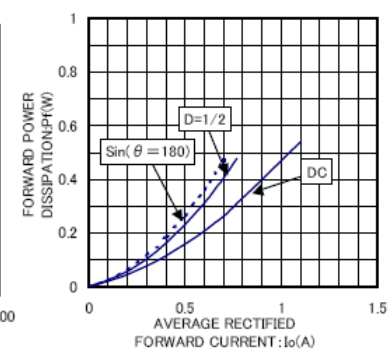
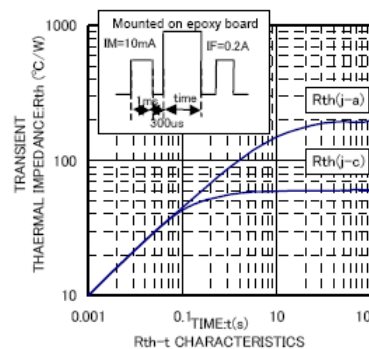
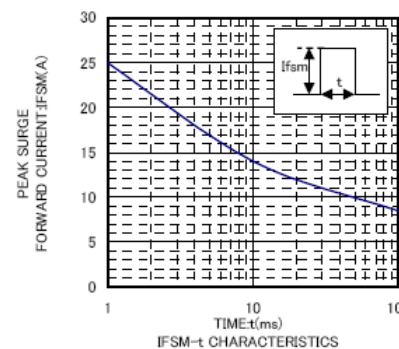
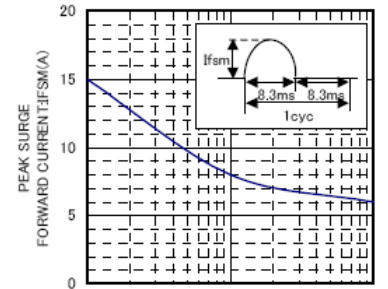
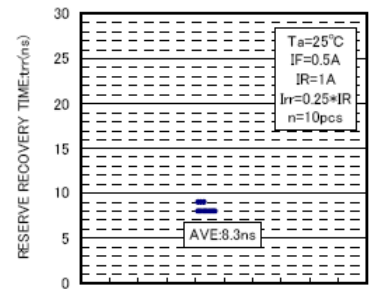
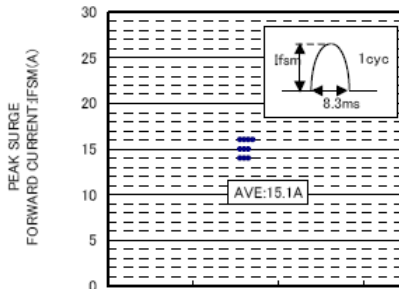
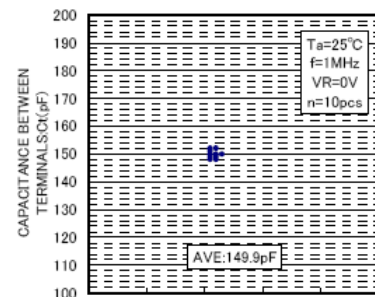
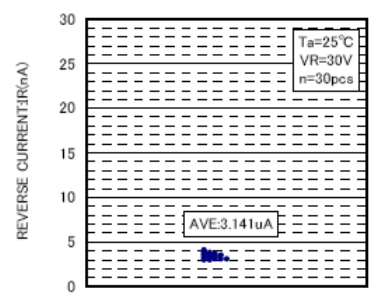
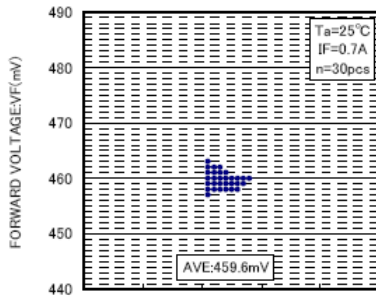
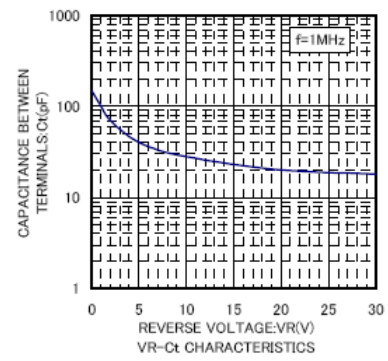
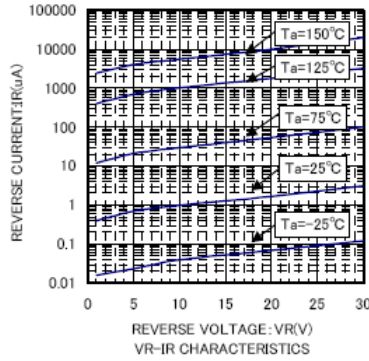
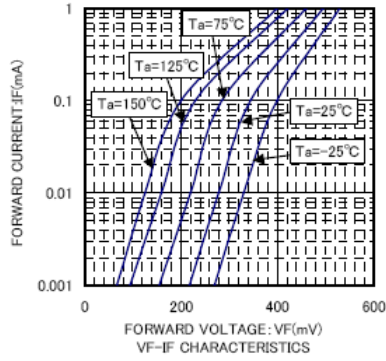

## PACKAGE OUTLINE

Plastic surface mounted package

SOD-323

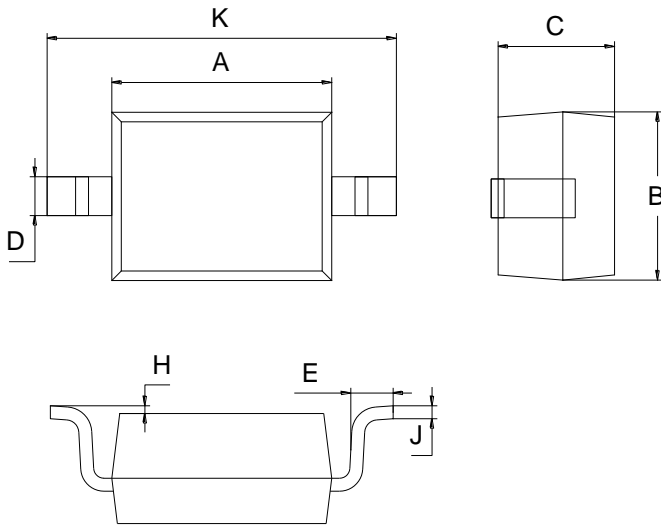

SOD-323		
Dim	Min	Max
A	1.60	1.80
B	1.20	1.40
C	0.80	0.90
D	0.25	0.35
E	0.22	0.42
H	0.02	0.1
J	0.05	0.15
K	2.55	2.75
All Dimensions in mm		

## SOLDERING FOOTPRINT

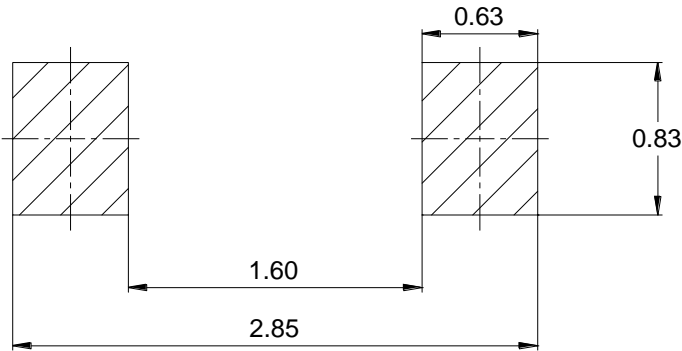

Unit: mm

## PACKAGE INFORMATION

Device	Package	Shipping
RB550V-30	SOD-323	3000 pcs / Tape & Reel