

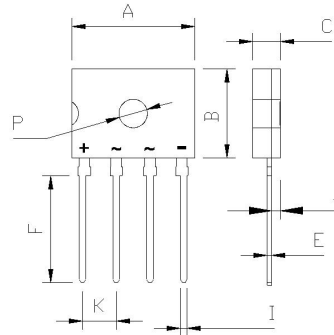

### D3K

### Features

- The plastic package carries Underwriters Laboratory Flammability Classification 94V-0
- Idea for printed circuit board
- Glass passivated Junction chip
- Low reverse leakage
- High forward surge current capability
- High temperature soldering guaranteed  
250 C/10 seconds at terminals



D3K		
Dim	Min	Max
A	13.65	14.15
B	9.80	10.20
C	2.95	3.25
E	0.35	0.65
F	11.70	12.30
I	0.65	0.95
J	0.90	1.20
K	3.60	4.00
P	Ø3.2Typical	
All Dimensions in mm		

### Mechanical Data

**Case** : Molded plastic body

**Terminals** : Solder plated, solderable per MIL-STD-750, Method 2026

**Polarity** : Polarity symbol marking on body

**Mounting Position** : Any

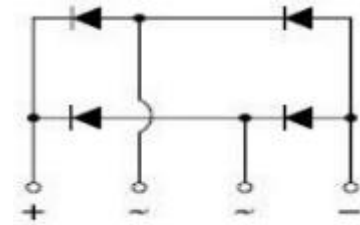

### Maximum Ratings And Electrical Characteristics

Ratings at 25 C ambient temperature unless otherwise specified. Single phase half-wave 60Hz, resistive or inductive load, for capacitive load current derate by 20%.

Parameter	SYMBOLS	D8K B05	D8K B10	D8K B20	D8K B40	D8K B60	D8K B80	D8K B100	UNITS
Maximum repetitive peak reverse voltage	$V_{RRM}$	50	100	200	400	600	800	1000	V
Maximum RMS voltage	$V_{RMS}$	35	70	140	280	420	560	700	V
Maximum DC blocking voltage	$V_{DC}$	50	100	200	400	600	800	1000	V
Maximum average forward rectified current with heatsink	$I_{(AV)}$	8.0							A
Peak forward surge current, 8.3ms single half sine-wave superimposed on rated load	$I_{FSM}$	170.0							A
Rating for fusing (t=8.3ms, $T_A=25^{\circ}C$ )	$I^2t$	120.0							$A^2s$
Maximum instantaneous forward voltage at 4.0A	$V_F$	1.10							V
Maximum DC reverse current $T_A = 25^{\circ}C$ at rated DC blocking voltage $T_A = 125^{\circ}C$	$I_R$	5.0 500							$\mu A$
Typical junction capacitance (Note 1)	$C_J$	56.0							pF
Typical thermal resistance	$R_{QA}$	55.0							$^{\circ}C/W$
Operating junction and storage temperature range	$T_J, T_{STG}$	-55 to +150							$^{\circ}C$

**Note:** 1. Measured at 1MHz and applied reverse voltage of 4.0V D.C.



### Ratings And Characteristic Curves

FIG. 1- DERATING CURVE OUTPUT RECTIFIED CURRENT

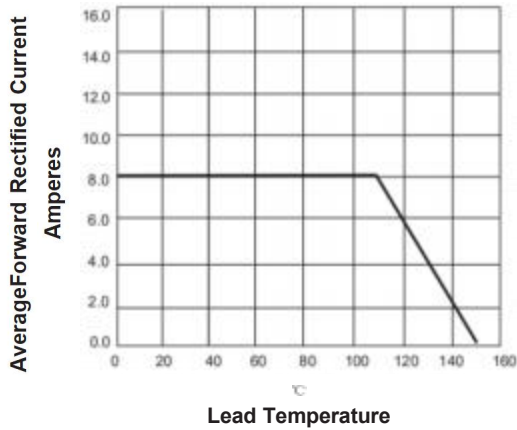

FIG. 2-MAXIMUM NON-REPETITIVE PEAK FORWARD SURGE CURRENT PER LEG

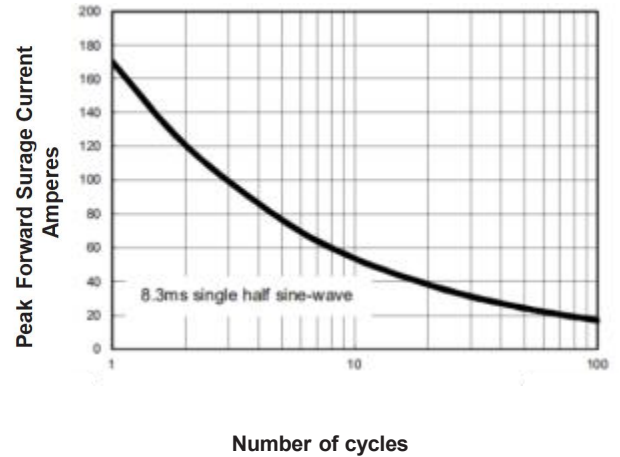

FIG. 3-TYPICAL FORWARD VOLTAGE CHARACTERISTICS

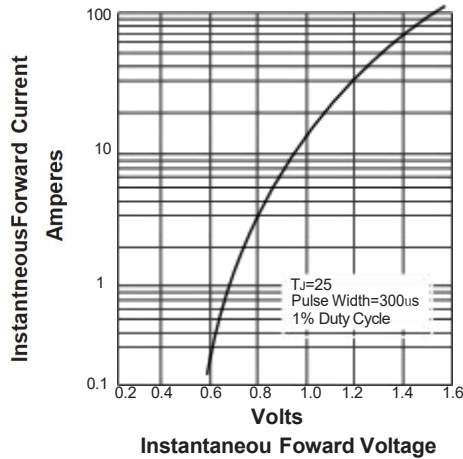
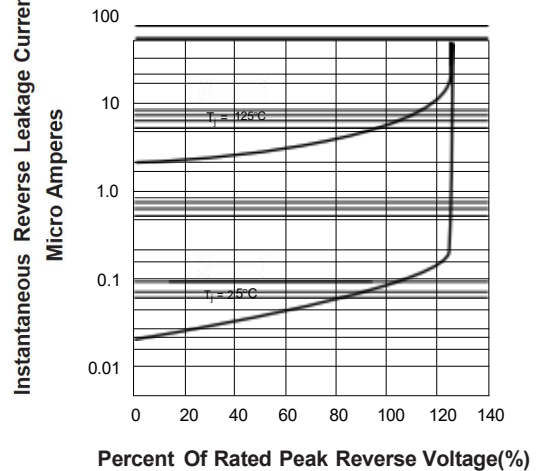

FIG. 4-TYPICAL REVERSE LEAKAGE CHARACTERISTICS



Package	Tube (mm)	Q'TY/Tube (Kpcs)	Box Size (mm)	QTY/Box (Kpcs)	Carton Size (mm)	Q'TY/Carton (Kpcs)
D3K	445*30.7*5.6	0.03	495*130*70	1.2	520*370*155	6