

FEATURES

- Rating to 1000V PRVP
- Surge overload rating to 40 Amperes peak
- Glass passivated chip junctions
- Reliable low cost construction utilizing molded plastic technique results in inexpensive product
- Lead solderable per MIL-STD-202 method 208
- Lead: silver plated copper, solderde plated
- Plastic material has UL flammability classification94V-0

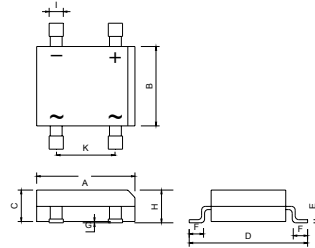
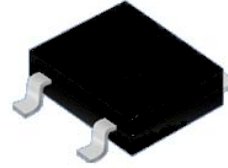

DBS		
Dim	Min	Max
A	7.80	8.50
B	6.10	6.50
C	2.35	2.65
D	9.80	10.20
E	0.15	0.35
F	0.90	1.50
G	0.20MAX	
H	2.50	2.80
I	1.00	1.40
K	4.80	5.20
All Dimensions in mm		

Maximum Ratings (@TA = 25°C unless otherwise specified)

Characteristic	Symbol	DF150S	DF151S	DF152S	DF154S	DF156S	DF158S	DF1510S	UNITS
Maximum Recurrent Peak Reverse Voltage	V_{RRM}	50	100	200	400	600	800	1000	V
Maximum RMS Reverse Voltage	V_{RMS}	35	70	140	280	420	560	700	V
Maximum DC Blocking Voltage	V_{DC}	50	100	200	400	600	800	1000	V
Maximum average forward Output current @TA=40°C	$I_{F(AV)}$	1.5							A
Peak forward surge current 8.3ms single half-sine-wave superimposed on rated load	I_{FSM}	50							A
Current squared time $t < 8.3ms$, $T_a = 25^\circ C$	I^2t	10							A ² s

Thermal Characteristics

Characteristic	Symbol	DF150S	DF151S	DF152S	DF154S	DF156S	DF158S	DF1510S	UNITS
Typical thermal resistance junction to lead	$R_{\theta JL}$	15							°C/W
On aluminum substrate	$R_{\theta JA}$	68							
Operating junction temperature range	T_J	-55 -- +150							°C
Storage temperature range	T_{STG}	-55 -- +150							°C

Electrical Characteristics (@TA = 25°C unless otherwise specified)

Characteristic	Symbol	DF150S	DF151S	DF152S	DF154S	DF156S	DF158S	DF1510S	UNITS
Maximum instantaneous forward voltage at 1.5A	V_F	1.1							V
Maximum reverse current @TA=25°C at rated DC blocking voltage @TA=100°C	I_R	5.0							μA
		0.5							mA



FIG.1 – TYPICAL FORWARD CURRENT DERATING CURVE

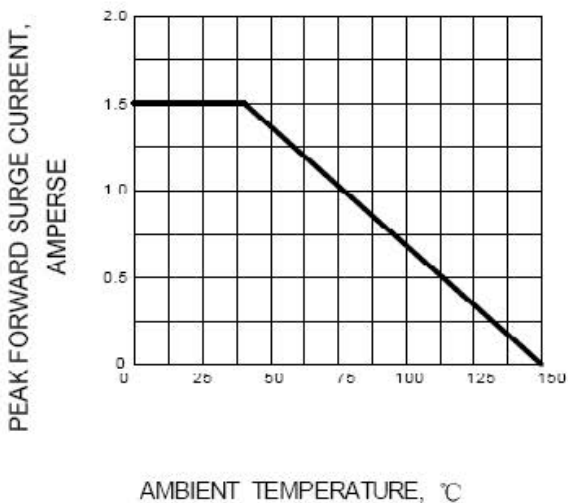

FIG.2 – MAXIMUM NON-REPETITIVE FORWARD SURGE

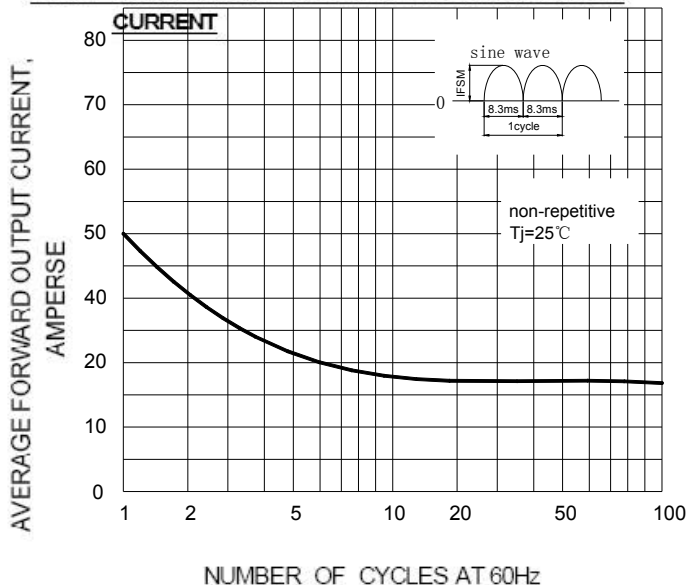

FIG.3 – TYPICAL FORWARD CHARACTERISTIC

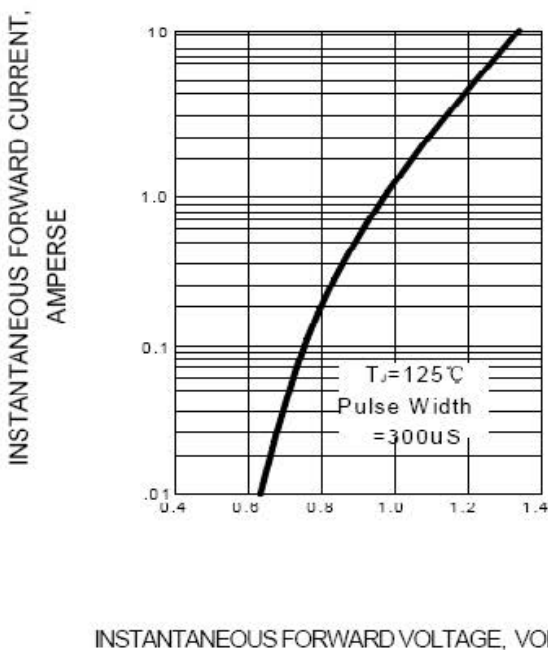
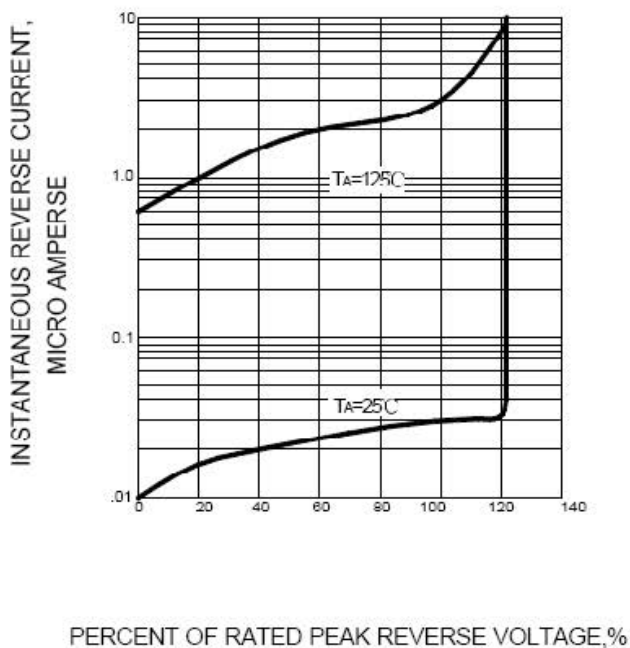

FIG.4 – TYPICAL REVERSE CHARACTERISTIC



Device	Package	SPQ/PCS
DB151S--DB157S	DBS	1500/REEL